

“ Nothing is in good taste unless it suits the way you live. What’s practical is beautiful And Suitability always overrules fashion.”

- BILLY BALDWIN

Indeed past of any region is very important and needs to be assimilated and digested well enough to know why and how it must be changed.

What’s more important in the whole process is that what the place wants to have and become ?

Hence the journey begins with the study of dwellings, these are the most sculpted model, a right thread of the history which has evolved with time and sculpted by climate and proved that it was always there and always will be engaged in slow but continuous adaptation and rediscovering itself.

Second important parameter are the institutions of the place that shape the people, they are very important thread that inspires existence of anything. They have always guided people and it is a communal agreement which binds all.

Third parameter is the culture. And culture of any place is the truth, a way of dwelling nurtured and guarded by institutions. It reinforces your primordial sense and is part of existence.

Our objective is to touch the sense of Timelessness in light of these clues.

Timelessness of monuments, forts and tombs which were built having strong presence in natural materials in their naked forms to capture invisible feel of force by space that moved humans.

The aim is to create a timeless landscape monumental but with humble scale as though it was always there for centuries, evoking the spirit of Ghana static and yet universal.

Geography, climate will be the prime focus along with clues and objective and aim is to strike a balance at the thresh hold of these.



Elevation expressing Blank facades.

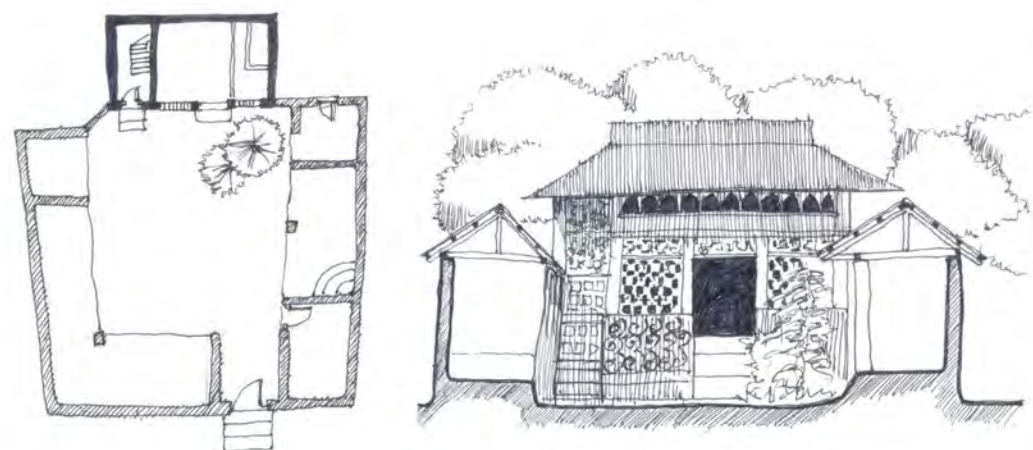

Inward looking quality towards courts are mostly encountered in traditional examples of habitats and institutions.

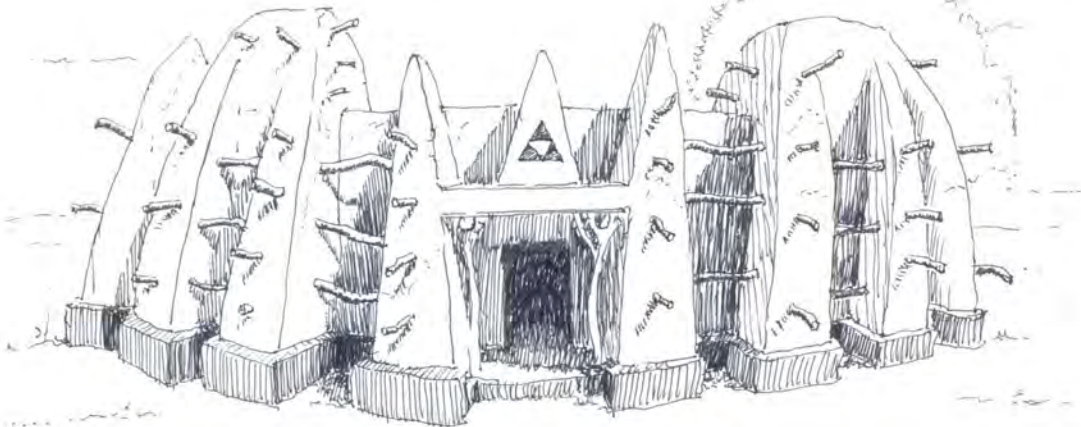
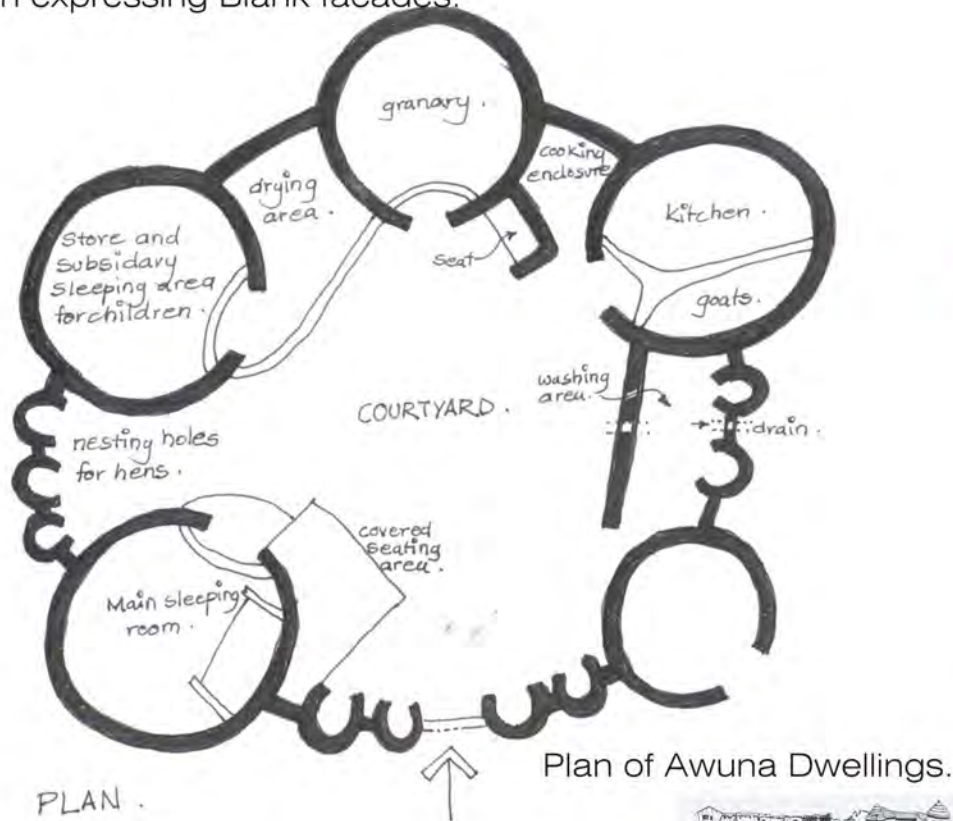

Markets and streets play a pivotal role in shaping communal spaces.



Permanence and spirituality of monuments can be felt even in contemporary times.



STRATEGIES

The prime responsibility of the new technique is to make past ideas work more efficiently.

Guest habitat cluster are developed by designing a single level economical module arranged around traditional court to form a cluster of eight guest habitat around a single court coupled with shaded verandah and walkways.

Idea is to bring down cost of single module and eventually of the cluster.

This cluster is then slightly rearranged to give a slight deflection in court volumes and changed directions of entrances.

These guest houses are so clustered with a separation of service grid to allow introduction of staircase for vertical expansion or to introduce a wind tower for efficient cooling.

Climate issues can be dealt by adapting conventional planning strategies for sun shading, ventilation to maximize comfort and lastly harvesting of water and its usage.

Use of wind towers can be opted if required where wind currents are sucked and passed over water body or a fountain and then the cooled air is passed on to the interiors.

Major part of construction will be in earth bricks and stone masonry. Masonry to be built upto 8 feet level which will support roof, this will prove economical and will chisel a humble scale to the units.

Use of cavity wall construction strategies like the rat trap bond masonry where 20 % bricks are saved and stability of conventional wall of similar wall thickness is achieved.

Use of ferrocement construction for spanning members instead of reinforced concrete construction can be employed to gain similar results and will be economical. Some of the advantages of ferrocement construction are:
Efficient structural design along with reduction in quantities of high-energy building materials and infrastructure facilities. Ferrocement has 1/5TH the thickness of conventional R.C.C slab.

Clusters are arranged to create axial streets and community courts of varying proportions.

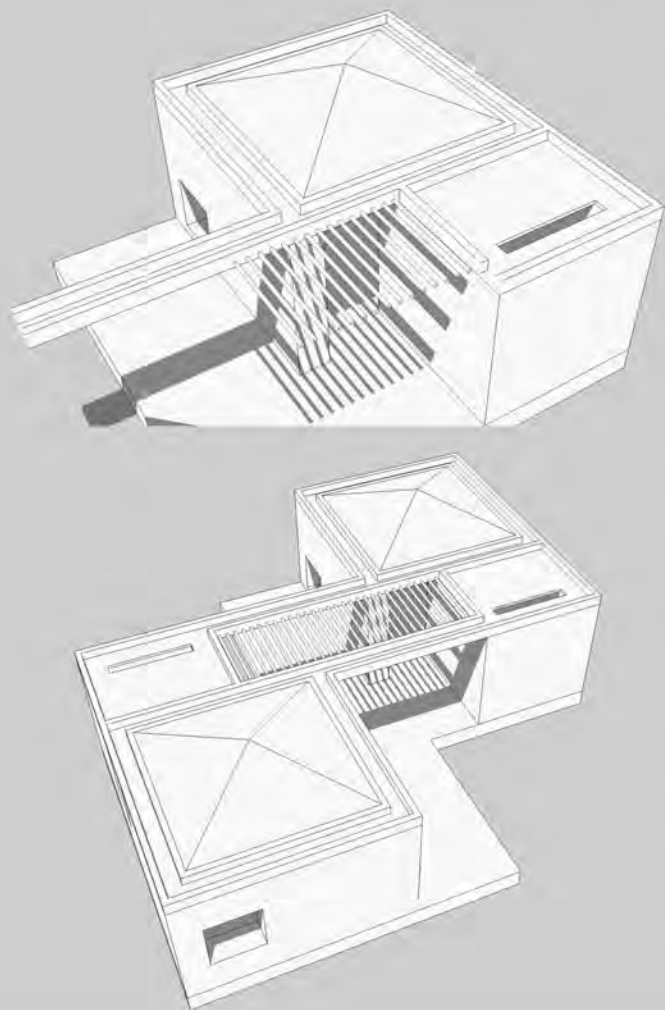

Wind towers are one effective way of cooling hot and dry winds with fair results.

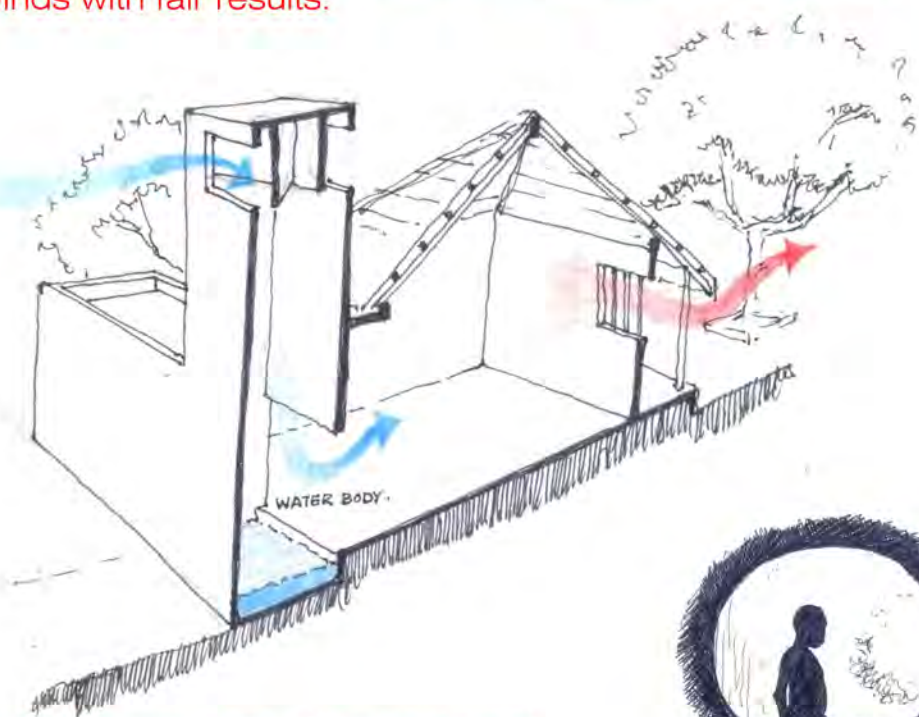

Key openings are effective way of synchronizing light in the interiors

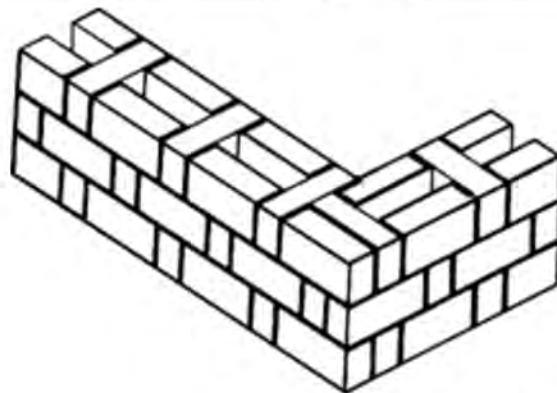

Rat trap bond masonry

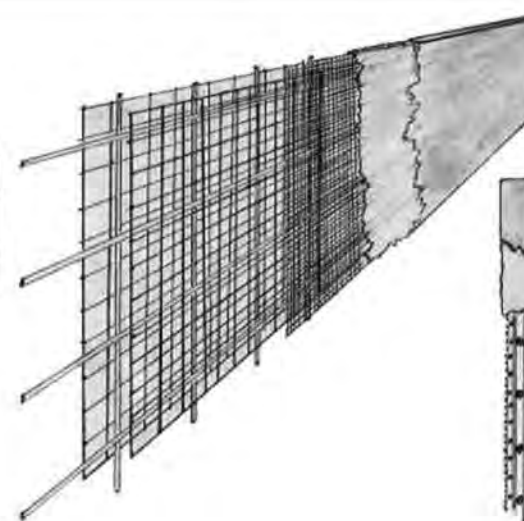

Ferrocement construction

